

**NOTE:**

- \* FORM IS REVERSIBLE BOTH VERTICALLY AND HORIZONTALLY
- \* BLOCKS STACK @ 1'-4" (16") INCREMENTS

**3** FRONT VIEW  
SCALE: 1 1/2" = 1'-0"

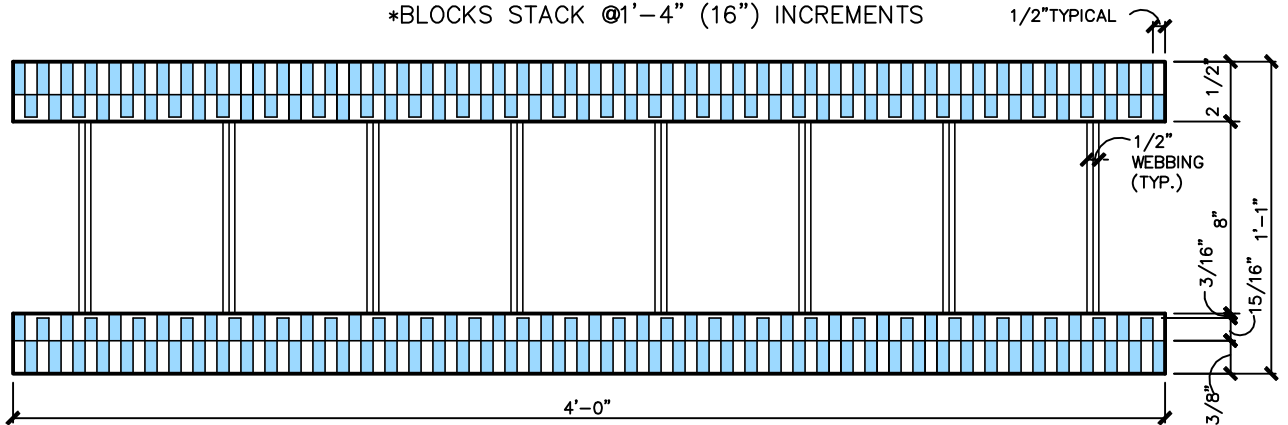

**2** TOP / BOTTOM VIEW (REVERSIBLE)  
SCALE: 1 1/2" = 1'-0"

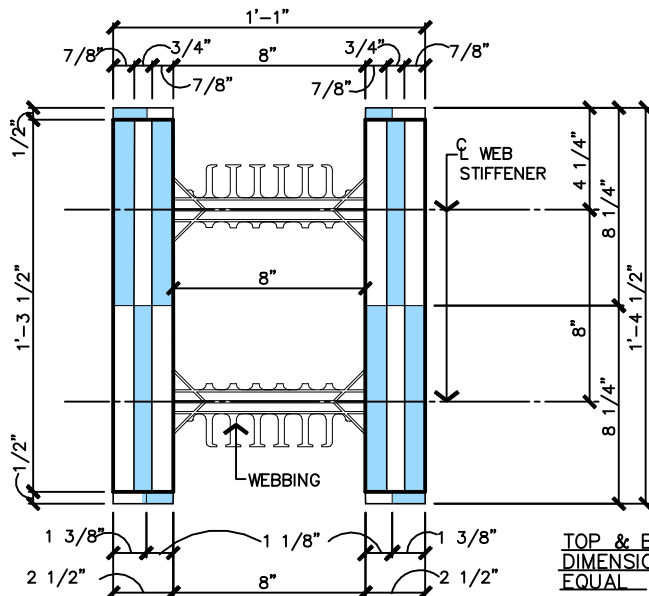

**1** SIDE VIEW  
SCALE: 1 1/2" = 1'-0"

**LEGEND**

- [Blue shaded area] = POSITIVE PROFILES (TONGUES)
- [White area] = NEGATIVE PROFILES (GROOVES)

**NOTE:**

DUE TO VARIATIONS IN SELECTED PRINTER SETTINGS, NOTED SCALES MAY NO LONGER BE APPLICABLE

**BB BuildBlock**  
BUILDING SYSTEMS, LLC

9701 N. Broadway Extension  
Oklahoma City, Oklahoma 73114  
www.buildblock.com

Office (405) 840-3386  
Fax (405) 840-0625  
Toll Free 1-866-222-2575

**8" STRAIGHT BLOCK**

DATE / REVISION	3-12-07 / 2	DETAIL SHEET
SCALE	AS NOTED	<b>03</b>
FILE NAME	BBDTL-03.AEC	

Construction shall be built in accordance with all applicable local and national building codes. All drawings are subject to change without notice.