

3 / 03 FRONT VIEW  
SCALE: 1 1/2" = 1'-0"

\*BLOCKS STACK @1'-4" (16") INCREMENTS

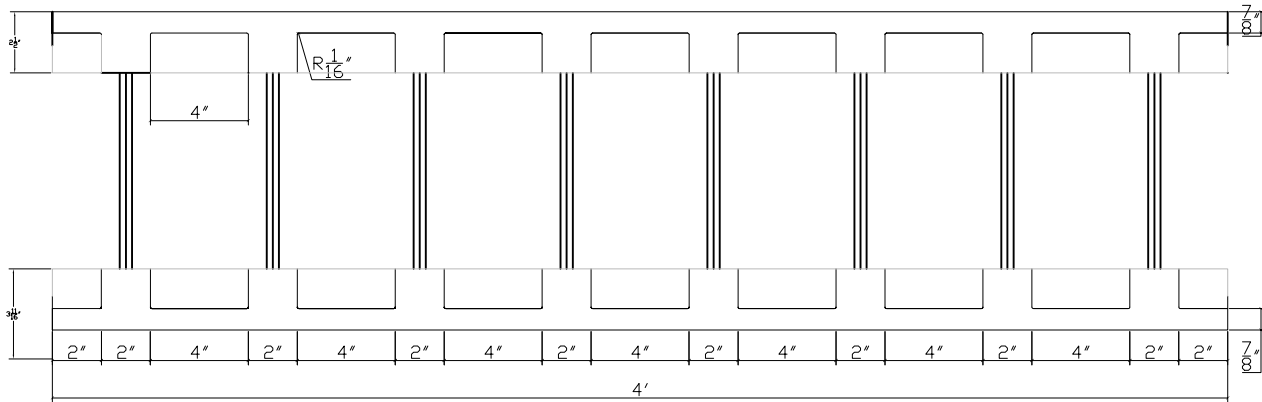

2 / 03 TOP / BOTTOM VIEW  
(REVERSIBLE)  
SCALE: 1 1/2" = 1'-0"

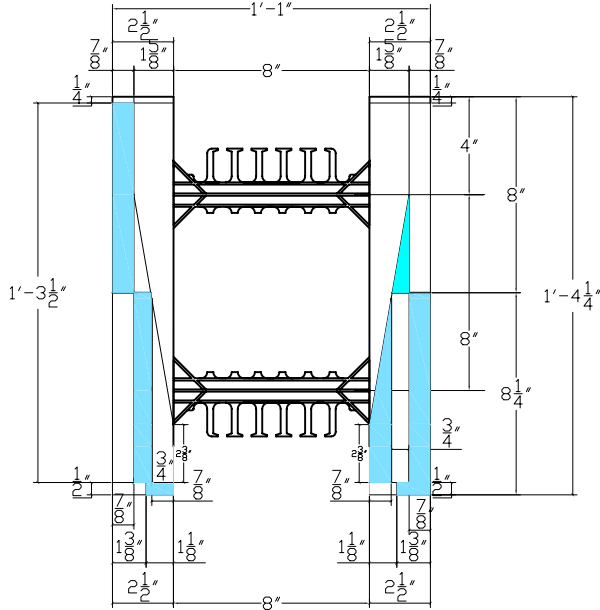

1 / 03 SIDE VIEW  
SCALE: 1 1/2" = 1'-0"

LEGEND

- = POSITIVE PROFILES (TONGUES)
- = NEGATIVE PROFILES (GROOVES)

NOTE:

THE BLUE AREA INSIDE THE RED IS THE SOLID AREA BELOW THE RED AREA AS WELL.



9701 N. Broadway Extension  
Oklahoma City, Oklahoma 73114  
www.buildblock.com

Office (405) 840-3386  
Fax (405) 840-0625  
Toll Free 1-866-222-2575

8" TAPER TOP BLOCK

|                 |          |                           |
|-----------------|----------|---------------------------|
| DATE / REVISION | 11-8-06  | DETAIL SHEET<br><b>5c</b> |
| SCALE           | AS NOTED |                           |
| FILE NAME       |          |                           |

Construction shall be built in accordance with all applicable local and national building codes. All drawings are subject to change without notice.